

# Paper Plate Flowers!



You will need:

- (5) 9-inch Paper Plates
- Hemp Cord or Metal Fasteners
- Round (not beveled) Pencil
- Marker or Round- Spoon
- Scissors
- Paint/paint brush

Step 1: Fold paper plate on dotted lines.

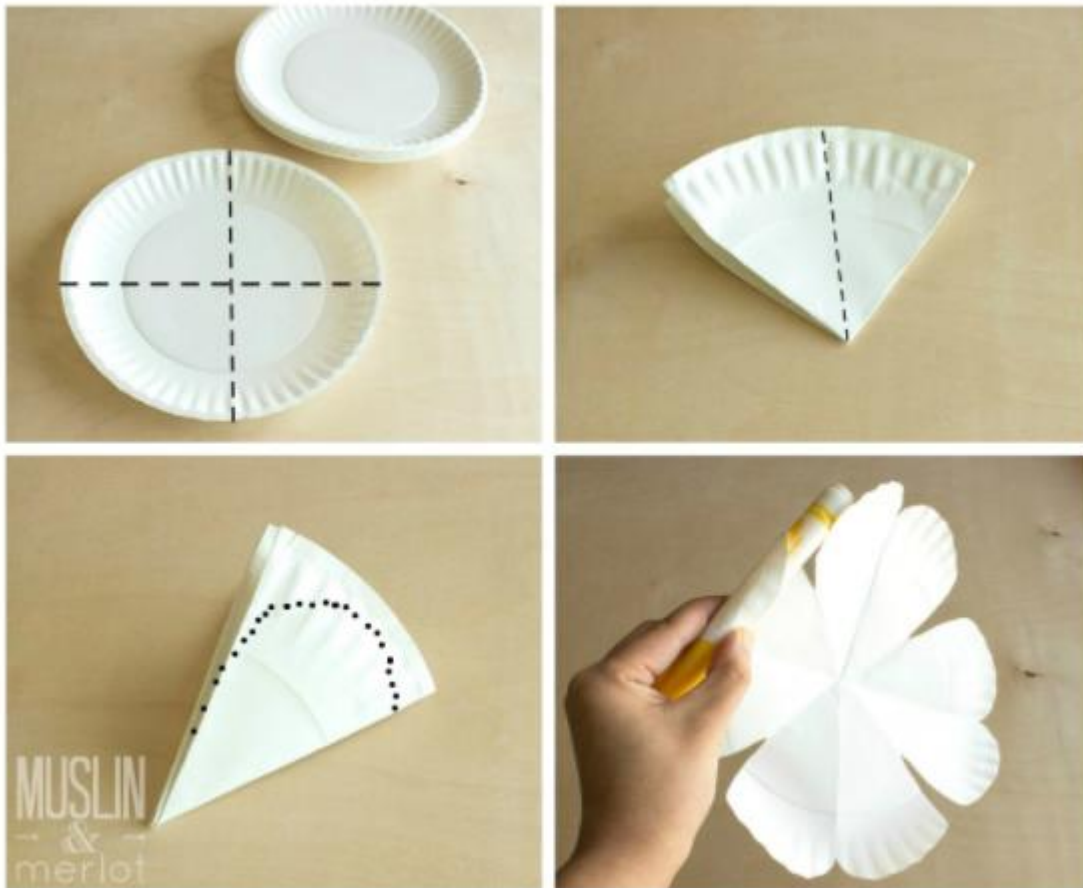

Cut paper on black dots. One side will be cut deeper than the other. You will end up with a shamrock once the plate is unfolded.

Bend each curved edge around a large marker or pencil.

## Step 2: Lay the first plate, curved edges DOWN



Fold and cut three more plates, each a little smaller than the last. Cut the edges evenly, not like the first plate. Save the cut edges! We'll use those later.

Use a pencil to curl the petals inward.

Step 3: Keep the leftover edges folded together. Cut off the top and bottom edge.

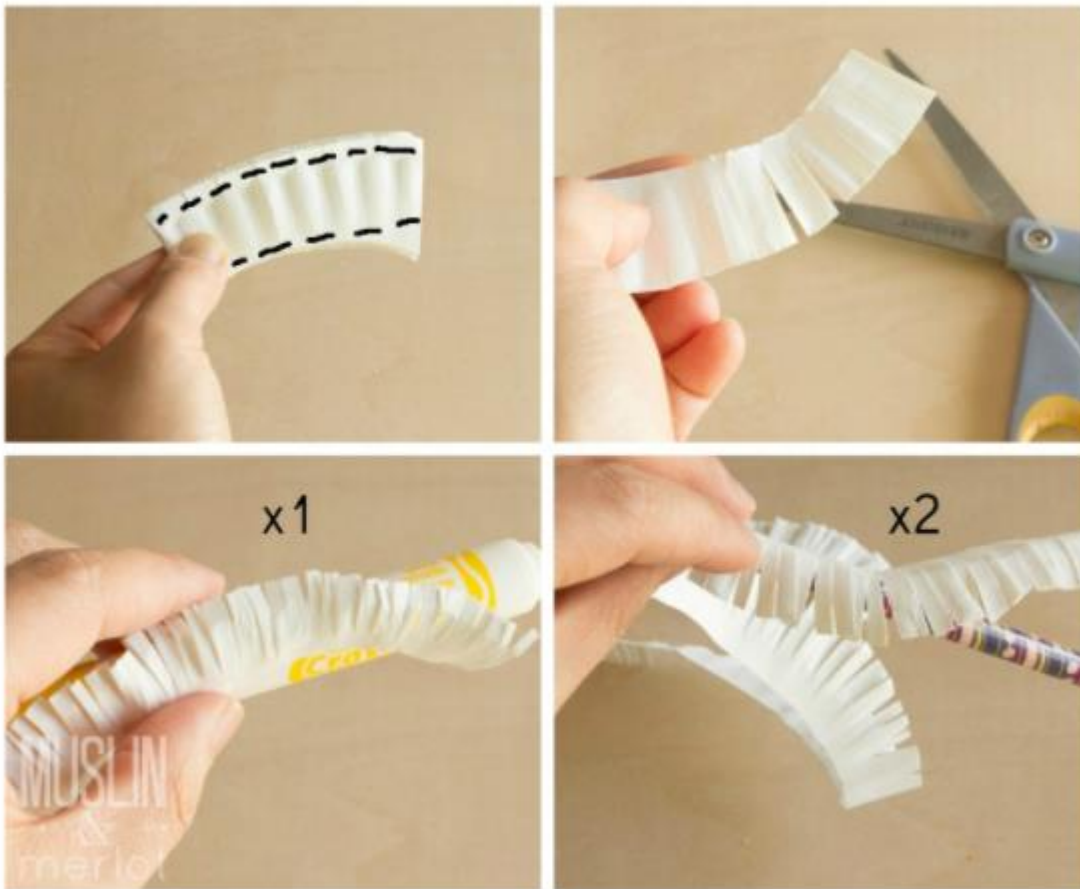

Still folded together, fringe the edge. Repeat with two more leftover edges.

Press the fringe of ONE leftover edges against a wide marker.

Press the fringes of TWO leftover edges against a pencil.

Step 4: Use the scissors blade or pencil to cut holes in the center of each flower.



Place a paper fastener through all the layers

OR cut a three foot length of hemp cord. Fold it in half. Make a knot at the folded end. Knot again once or twice.

Thread the hemp through the flower petals. The knot should be in the center of the flower.

Tie and knot the hemp at the back of the flower.

Pull the hemp straight. Knot the end.

Cut a medium piece from the fifth plate. Sandwich the hemp between the back of the flower and the medium piece of plate. Glue in place.



Step 5: Start rolling up the pencil-curved fringe. Make sure the fringe is pointing outward.



Leave it slightly loose in the center so that it will fit over the hemp knot. Glue at regular intervals until you reach the end of the first fringe. Glue the end to the second fringe. Keep rolling. Glue third (marker-rolled) fringe.

Place hot glue all over blue areas. Press and hold together until the glue cools.

Decide how to layer the petals. I offset my petals (third picture below) so that it would look like a full-blown tea rose.

Add drops of glue between the petal layers to help keep the petals in place.



Then use a fan brush and watercolors to give them a beautiful tinted hue.

